

# Wet multi disc brake 6,5"

(pull rod actuated)

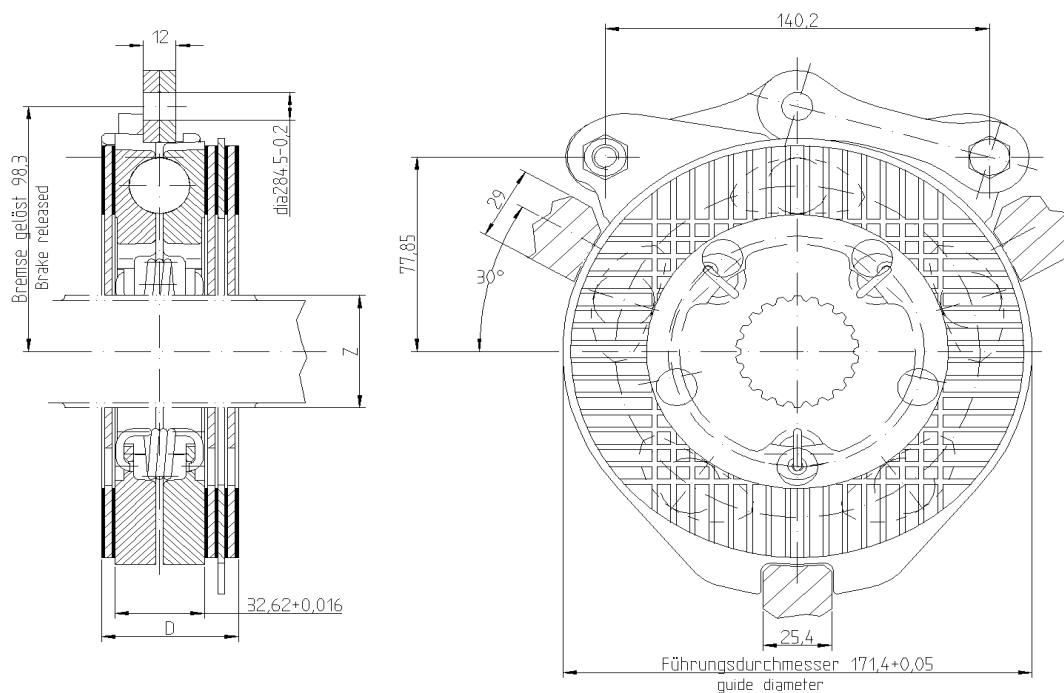

**special types on request**

Art. no.	max. brake-torque [Nm]	lining-quality	lining type	groove pattern	ramp angle	Monoservo/ Multiservo	number of lining discs	number of intermediate discs	D	Spline (Z)
12943	1000	HO 112.5	Papier	2-fach-parallel	24	Mono	3	1	49,92	A 45x41 DIN 5482
12917	1300	HO 112.5	Papier	2-fach-parallel	24	Mono	4	2	57,42	A 45x41 DIN 5482